

CATALOGUE

BLOCK TEK DECKING

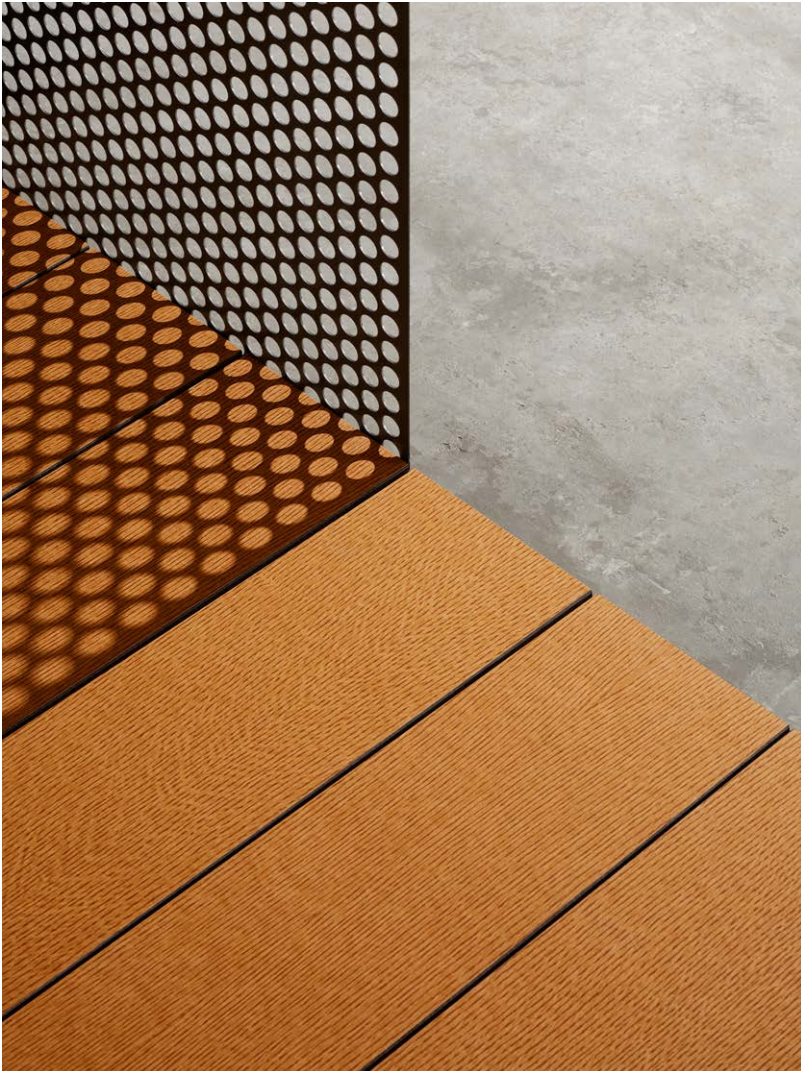

Parklex[®]



CATALOGUE

BLOCK TEK DECKING

Parklex[®]



Block Tek is a high-density composite floor for exteriors that is highly resistant to atmospheric changes in moisture and temperature.

It repels stains, mould and bacteria, so it is ideal for terraces and the area around swimming pools. It has obtained a rating of Class 3, which is the highest slip resistance rating according to the UNE-ENV 12633 standard.



Product: Block Tek / Finish: Tobacco
Roof of a Hotel in Barcelona, by Daniela Hartmann
(Barcelona, Spain)

No maintenance

The surface composition of Parklex® products protects against adverse weather conditions, eliminating the need for any maintenance or treatment.

Uniqueness

The texture on the surface of each Block Tek panel is unique, thus no patterns are generated in composition.

Resistant to changes

Extremely resistant to atmospheric changes in humidity and temperature, it is also highly resistant to UV light, such that the colour of the material remains stable over time.

Slip resistant

Block Tek exterior flooring is rated Class 3, the best possible slip resistance rating according to the UNE-ENV 12633 regulation.

Antiseptic

Due to its high density, this composite repels stains, fungus and bacteria.

PEFC certified

PEFC certified Block Tek is available upon request.

Made in the European Union

Complying with European regulations, at Parklex® we guarantee the quality in our manufacturing process, the safety of our employees and, of course, that of our customers.

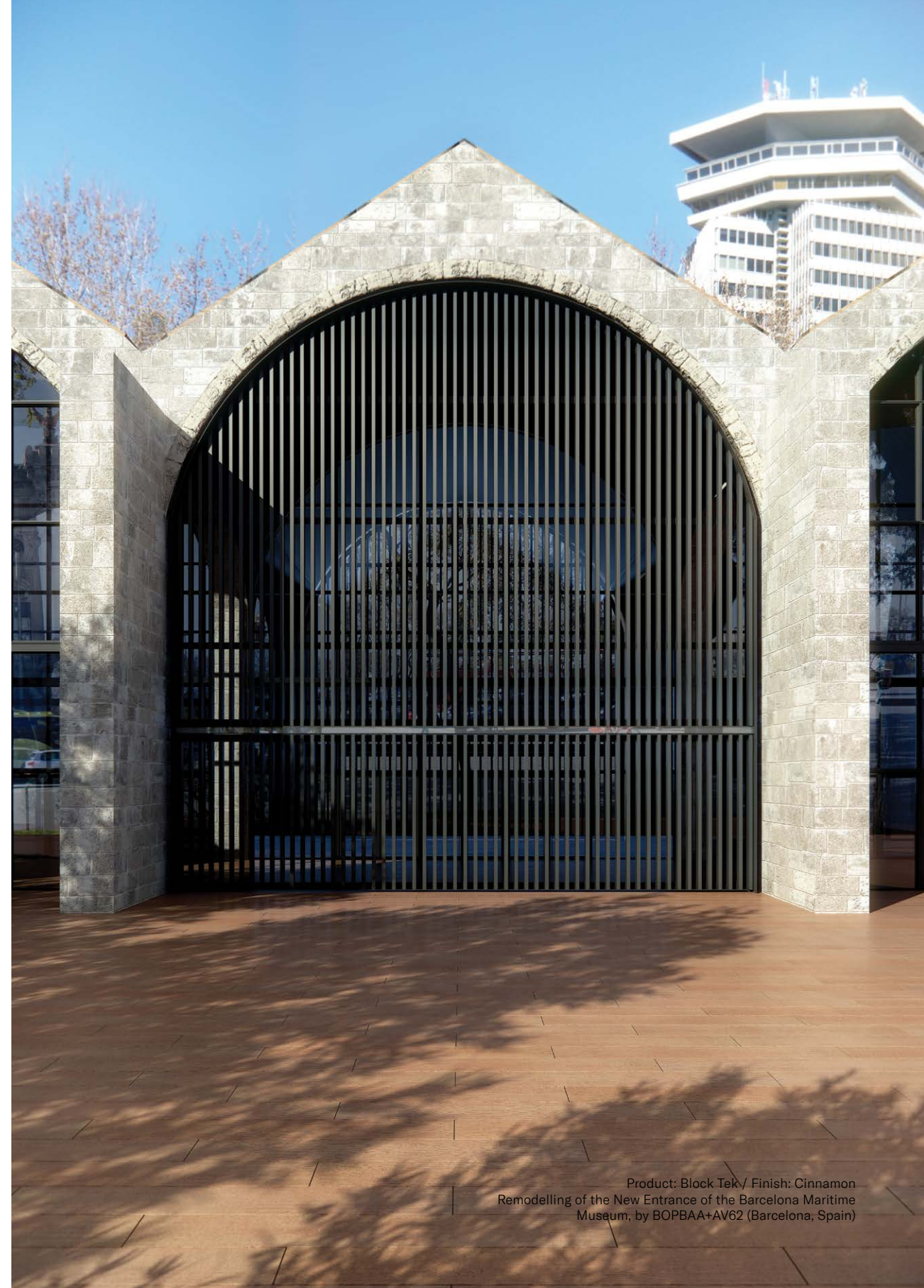



Product: Block Tek / Finish: Cinnamon
Private Villa in Torri del Garda, by Rocchi Piubello Architettura
(Verona, Italy)



Product: Block Tek
House in Roses, by Jordi Hidalgo i Tané (Roses, Spain)

Each board is unique. We make sure that the texture of the surface varies from one panel to another, in order to avoid repeated patterns in any composition. Block Tek decking is available in 6 different finishes and 3 standard widths: 130, 198 and 300 mm.



CINNAMON



CINDER



TOBACCO



CHIA



SESAME



MUSTARD

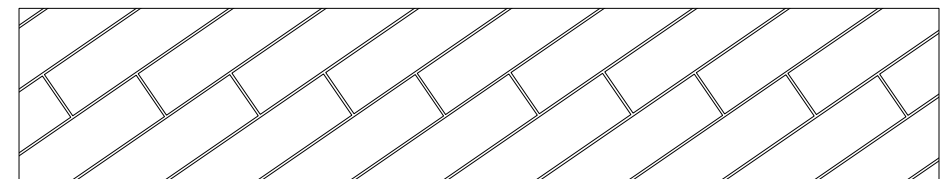
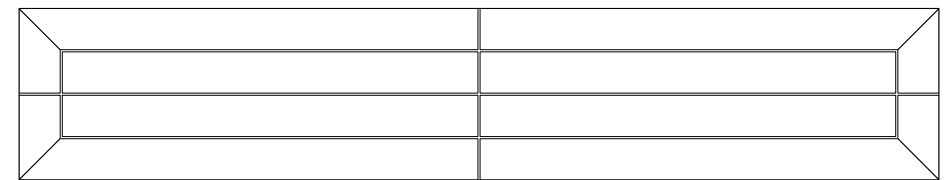
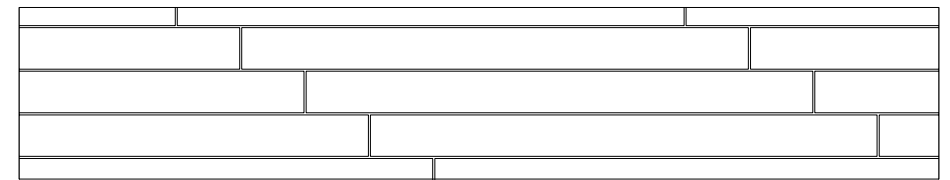
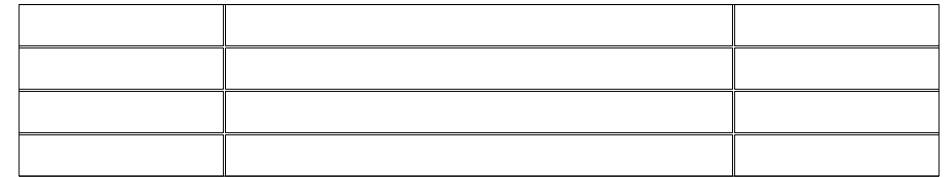

The assembly pattern must be studied before starting the work since installation of the supporting substructure will depend on the pattern used.

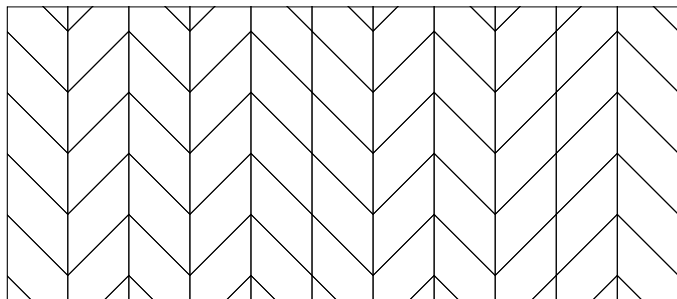
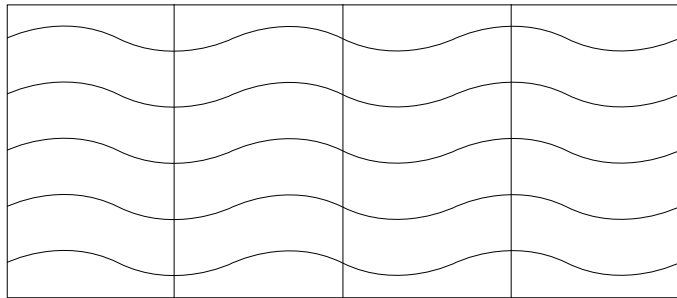
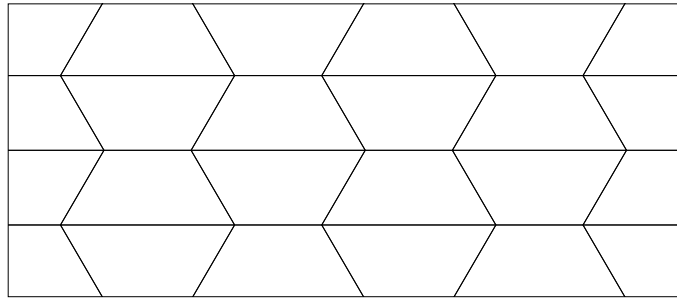

We offer the possibility of creating bespoke decking by cutting Block Tek panels in both straight and curved shapes, and to combine several finishes in one composition.

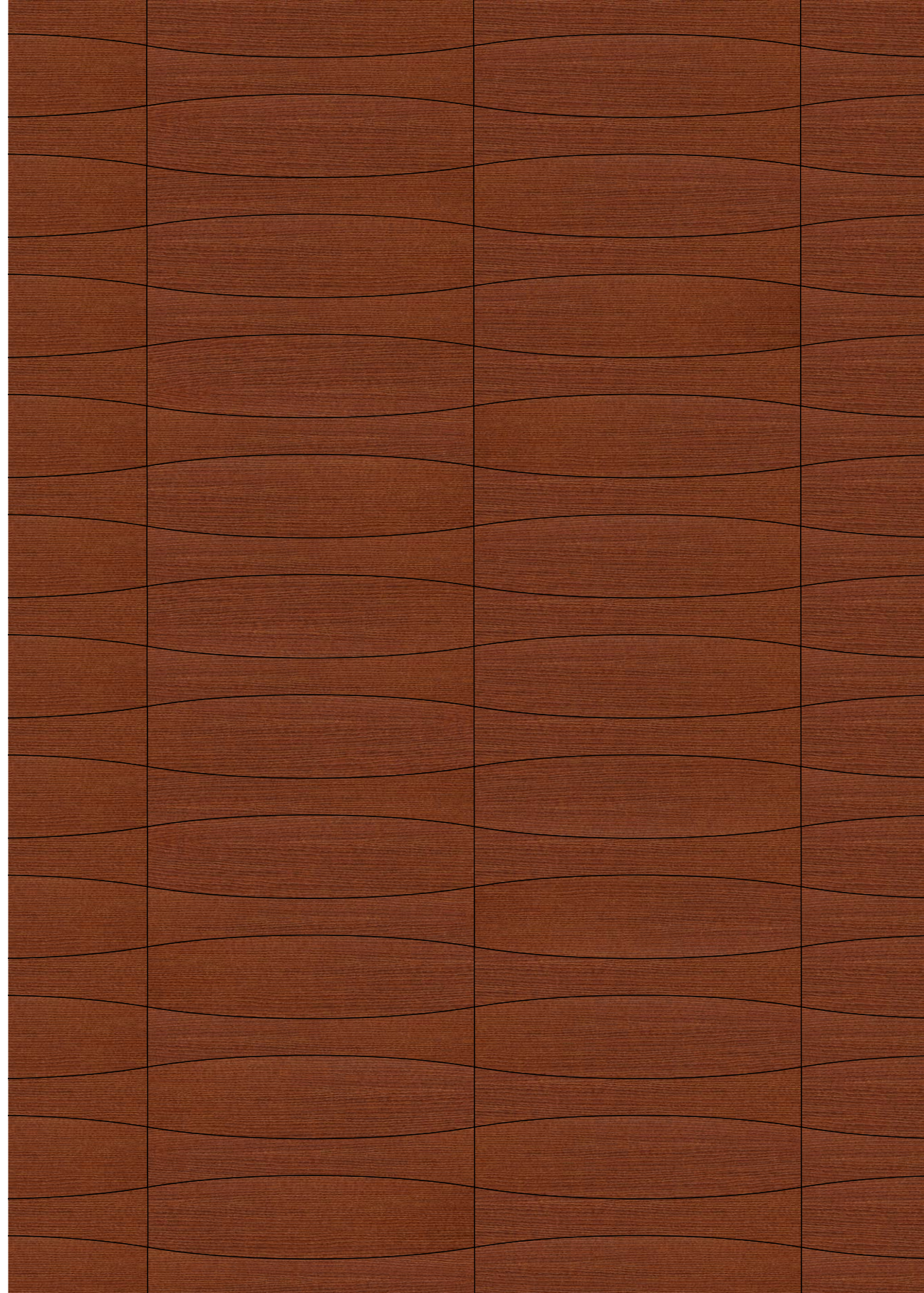



Product: Block Tek / Finish: Cinder
Hotel Atalaia (Irun, Spain)

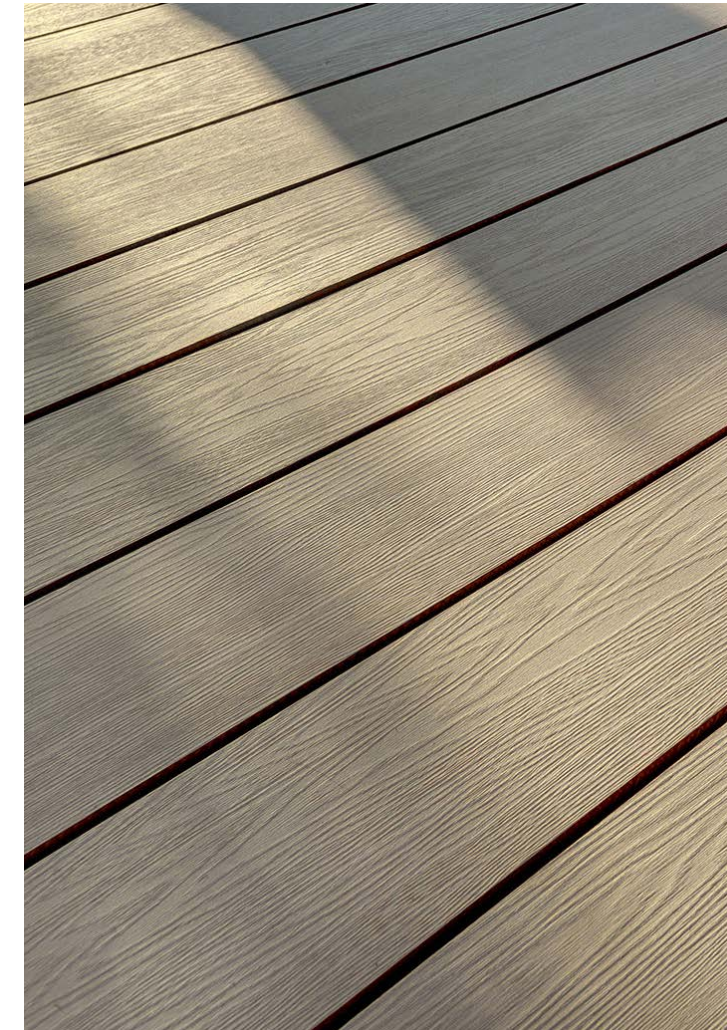

Block Tek decking can be installed with screws, staples or with an adhesive system over a supporting substructure.

Perimeter expansion joints must be left at the end and along the length of the boards in order to allow them to move, freely expand or contract, and to facilitate the evacuation of water or snow.

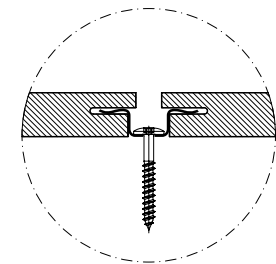
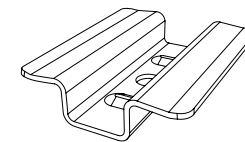
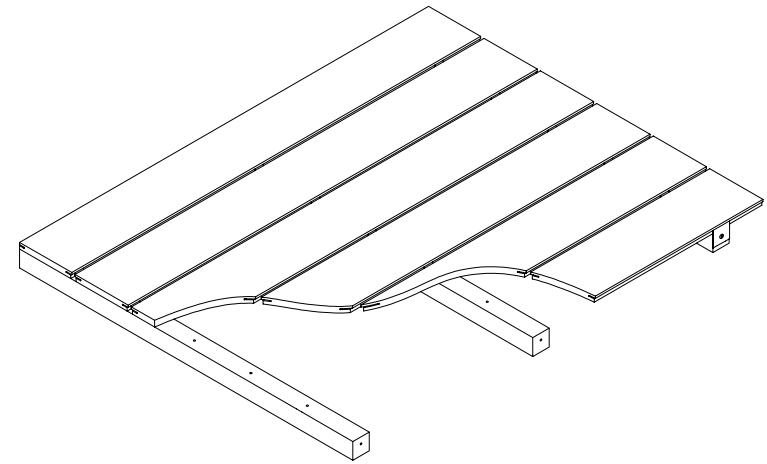

Block Tek can be installed with an invisible fixation system using staples. This system is only available for 14 mm-thick boards that are supplied with their longitudinal edge machined.

When using this system, the maximum available board width is 198 mm.

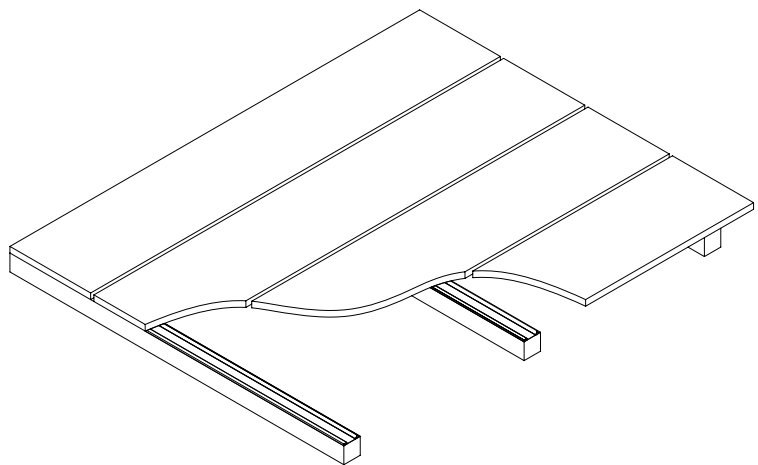

Parklex® has obtained a strict and appropriate procedure for gluing Block Tek panels from the adhesive manufacturer.

Given the continuous variations in adhesive design and applications, we recommend that you consult us on the most recent application procedure if you want to use this system.

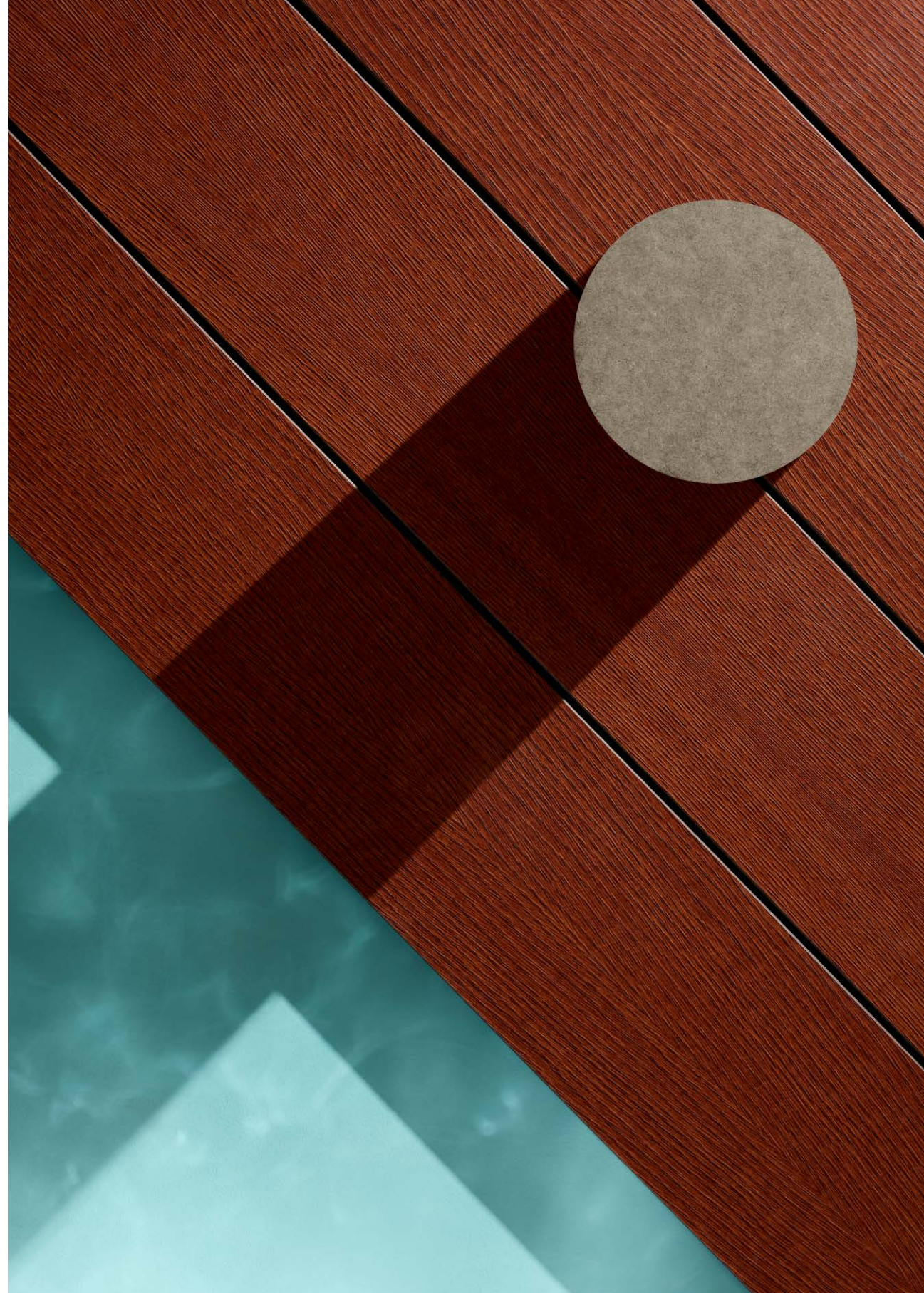



To install Block Tek, Parklex® offers screws, staples and substructural profiles.

Tests	Standard	Property or attribute	Unit of measurement	Result
				Parklex® Block Tek Rev: 01 (07.2015)
1. Inspection				
Colour, pattern and surface finish	EN 438-8 Part 5.2.2.3	Each surface texture must be considered as unique. The presence of slight differences in colour and structure is normal. Peculiarities such as knots or resin inclusions are not considered to be defects, but as part of the decoration.		
2. Dimensional tolerances				
Thickness (t)	EN 438-2 Part 5	10 14	mm	± 0.50 ± 0.60
Length and width	EN 438-2 Part 6	-	mm	+10 / -0
Edge straightness	EN 438-2 Part 7	-	mm/m	1.5
Edge squareness	EN 438-2 Part 8	-	mm/m	1.5
3. Physical properties				
Dimensional stability at elevated temperatures	EN 438-2 Part 17	Cumulative dimensional change	% max. longrain % max. crossgrain	0.3 0.6
Tensile strength	EN ISO 527-2	Longrain Crossgrain	MPa	≥ 60
Brinell Hardness	EN 1534	Hardness	MPa	≥ 100
Resistance to staining	EN 438-2 Part 26	Acetone, MEK and Ethyl acetate	Rating	1
Resistance to staining	EN 438-2 Part 26	Group 1, 2, 3 and (A)	Rating	5
4. Weather resistance requirements				
Resistance to UV light	EN 438-2 Part 28 Rating according to EN 20105 - A02	Contrast Appearance	Grey scale rating Rating	≥ 3 ≥ 4
Resistance to artificial weathering (including light fastness)	EN 438-2 Part 29 Rating according to EN 20105 - A02	Contrast Appearance	Grey scale rating Rating	≥ 3 ≥ 4
Resistance to salt spray	UNE EN ISO 9227	Appearance	Rating	0 (No alteration)
Termite resistance	EN 350 (EN 118)	Termite resistance	Class	D (Durable)
Fungal resistance	EN 350 (EN 113)	Fungal resistance	Class	1 (Very Durable)
5. Other requirements				
Flexural strength	EN ISO 178	Longrain Crossgrain	MPa	≥ 80
Flexural Modulus	EN ISO 178	Longrain Crossgrain	MPa	≥ 9,000
Thermal resistance/Conductivity	EN 12664	Thermal conductivity (λ)	W/m K	0,261
Resistance to climatic shock	EN 438-2 Part 19	Appearance Flexural strength Elastic modulus	Rating Ds Rating Dm Rating	≥ 4 ≥ 0.95 ≥ 0.95
Density	EN ISO 1.183	Density	g/cm³	≥ 1.35
Resistance to wet conditions 48h 65°C	EN 438-2 Part 15	Moisture absorbed Appearance	% Rating	≤ 2 ≥ 4
Resistance to wet conditions 24h 20°C	EN 317	Moisture absorbed Thickness increased	%	≤ 1 ≤ 2
Assessment of static electrical propensity	EN 1815	Potential difference	KV	< 2 (Antistatic)
Dynamic coefficient of friction on dry surfaces	EN 13.893	Slip resistance	μ	0.64 (DS)
Slip / skid resistance	BS 7678	Slip resistance	PTV	> 45
Ramp slip resistance	DIN 51130	Slip resistance	Class	R10
Ramp slip resistance	DIN 51097	Slip resistance	Class	C
6. EC Safety requirements - Reaction to fire				
Reaction to fire	EN 13.501-1	Euroclass	Classification	Bfl-s1

(A) Other products used: CIF, Ammonia, bleach, mayonnaise, ketchup, mustard, hand cream, wine vinegar and oil.

EDITING & PRODUCTION
PARKLEX INTERNATIONAL S.L.U.

ART DIRECTION
JAUME RAMÍREZ STUDIO

TEXT
CHESCA GUIM

PHOTOGRAPHY
MARÇAL VAQUER
JARA VARELA
YOSIGO

INFOGRAPHICS
ESTUDI CREAD

PRINTED IN BARCELONA
BY AGPOGRAF

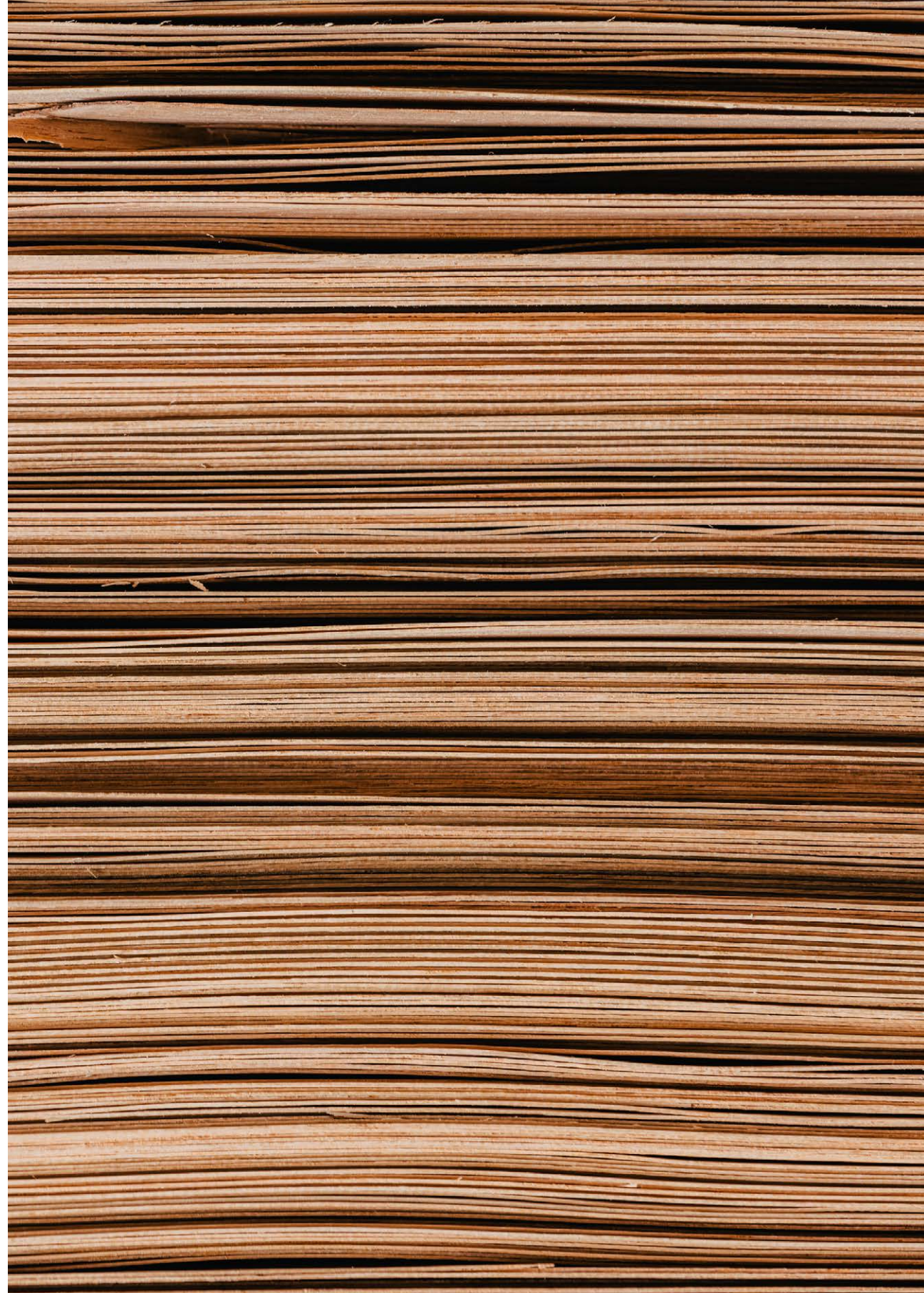

PARKLEX
POLÍGONO ALKAIAGA, C/BALDRÚN
31780 BERA - NAVARRA - SPAIN
TEL. +34 948 625 045
PARKLEX@PARKLEX.COM

WWW.PARKLEX.COM